

**Subject:** Inspection or modification of elevator and elevator trim control system

**Concerned:** G 115/ G 115A/ G 115B, all S/N's

**Urgency:** Action A., B., C.: at the next annual inspection,  
not later than 31 December 1993  
Action D.: optional

**Procedure:** On aircraft, which are permanently exposed to aggressive climatic conditions (i.e. sea area), and have not been adequately maintained, corrosion has been detected on elevator levers and at the elevator trim control system in the area of the horizontal tail. An inspection for corrosion, and, if corrosion is determined, an exchange of the concerned parts for parts made from non-corrosive material is mandatory as a precautionary measure.

**Actions:** A. All parts of the elevator trim control system in the horizontal tail area must be inspected visually for corrosion.

Corroded parts must be exchanged (refer to sketch).

**Note:** The stud bolt plate (21), covered with laminate, must not be exchanged necessarily. It is permissible to remove corrosion from stud bolts and protect stud bolts with corrosion protective (e.g. LPS 3).

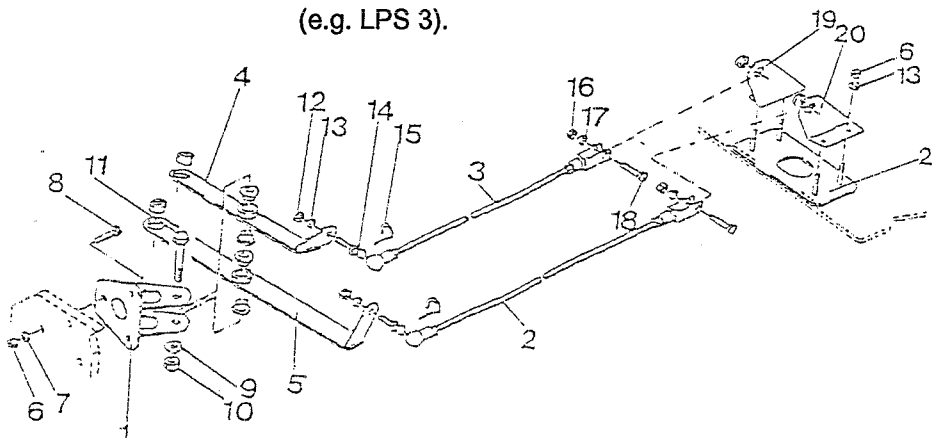

Item	Name	P/N	Item	Name	P/N
1	Trim lever mounting bracket 2	115-4297	12	Nut	LN 9348-M5
2	Trim rod 6	115-4446	13	Washer	LN 9025-5,3
3	Trim rod 7	115-4447	14	Ball bolt	A 8 SxN 03/2
4	Trim lever 4	115-4301	15	Locking spring	AS8 - SF
5	Trim lever 5	115-4303	16	Nut	LN 9348-M4
6	Nut	LN 9348-M5	17	Washer	LN 9025-4,3
7	Washer	DIN 9021-5,3	18	Screw	LN 9037-M4x18
8	Screw	LN 9037-M5x20	19	Bracket R/H	115-3576
9	Washer	LN 9025-6,4	20	Bracket L/H	115-3575
10	Nut	LN 9348-M6	21	Stud bolt plate	115-3553
11	Screw	LN 9037-M6x40			

- B. The inspection or the exchange of the elevator mounting (lever L/H P/N 115-3573 and lever R/H P/N 115-3572) must be performed as follows:
1. Remove rudder, according to MM Chapter 27-20-30
  2. Remove elevator, according to MM Chapter 27-30
  3. Check L/H and R/H lever through the hole for internal corrosion (refer to sketch)

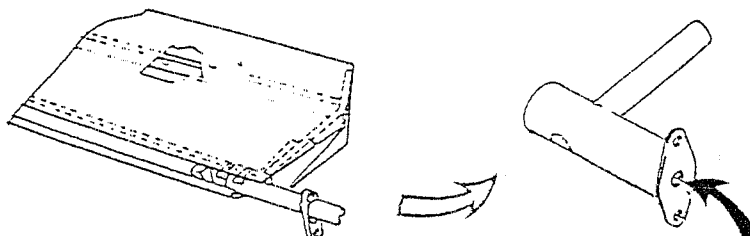

4. If corrosion is detected, the elevator mounting (lever L/H P/N 115-3573 and lever R/H P/N 115-3572) must be exchanged.

For exchange, the elevator must be sent to the manufacturer.

**Note:** If the extent of corrosion can not be determined exactly, the elevator may be sent to the manufacturer for inspection.

5. If the corrosion is only surface corrosion (very thick film of rust), the corrosion must be removed as far as possible and the lever protected internally using a proper corrosion protective (e.g. LPS 3), to restrict further corrosion.

The rate of corrosion must then be checked periodically (minimum every 100 hours or during each annual inspection). If the aircraft is exposed to extreme weather conditions, (e.g. high humidity, high temperatures, sea climate) the inspection interval must be shorter.

6. Weigh elevator and determine residual momentums, according to MM Chapter 06.

7. Install elevator, according to MM Chapter 27-30.

**Note:** The installation of an auxiliary hinge ring is recommended for an easier assembly (refer to IM 115-19). A 6 mm longer hinge bolt must be used! (refer to sketch)

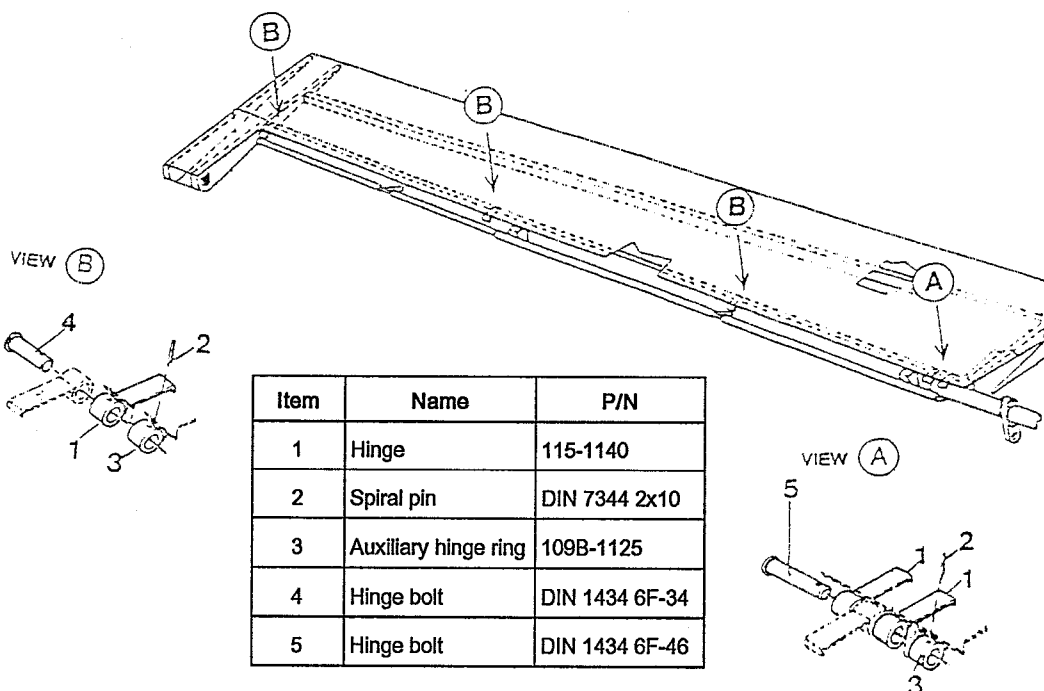

Item	Name	P/N
1	Hinge	115-1140
2	Spiral pin	DIN 7344 2x10
3	Auxiliary hinge ring	109B-1125
4	Hinge bolt	DIN 1434 6F-34
5	Hinge bolt	DIN 1434 6F-46

**C. Check trim rod 3 for corrosion.**

If corrosion is detected, trim rod 3 must be exchanged according to MM Chapter 27-40.

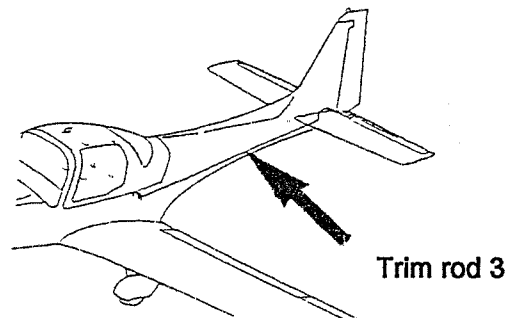

**D. Installation of an additional elevator hinge.**

To prevent delamination of the outboard elevator hinge, an additional elevator hinge can be optionally installed according to Installation Instructions No. 1078-30.

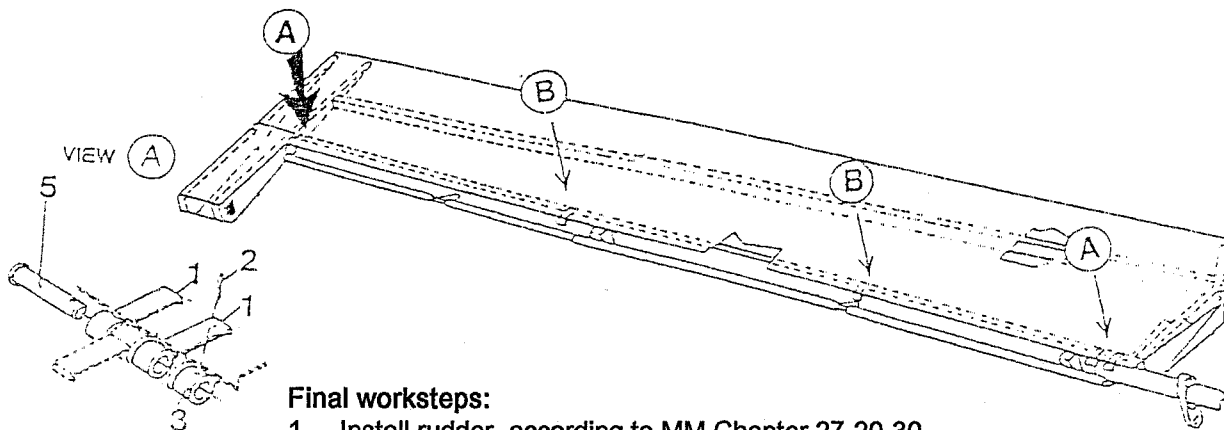

**Final worksteps:**

1. Install rudder, according to MM Chapter 27-20-30.
2. Check adjustment of elevator, elevator trim and rudder control systems, according to MM Chapter 06.
3. Perform functional test of elevator, elevator trim and rudder control systems.

**Material:**

The material can be obtained from GROB.

**Weight and Balance:**

Empty weight and empty weight c.g. must be determined newly after performing action B. and D.

**Remarks:**

1. The exchange of the elevator mounting (lever L/H P/N 115-3573 and lever R/H P/N 115-3572) can only be performed by GROB or in arrangement with GROB. For this the elevators must be sent to GROB.
2. If you have sold your aircraft in the meantime, would you kindly pass this information on to the new owner and forward his name and address and aircraft S/N to us.

Mattsies, 13 August 1993

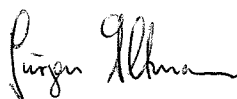

Dipl. Ing. J. Altmann  
(Airworthiness engineer  
certification staff)

**LBA approved:**

This Service Bulletin is originally written in German and approved by the German LBA on the 14 October 1993. The translation has been accomplished to the best of our knowledge and judgement. In case of doubt, the German original is authoritative.



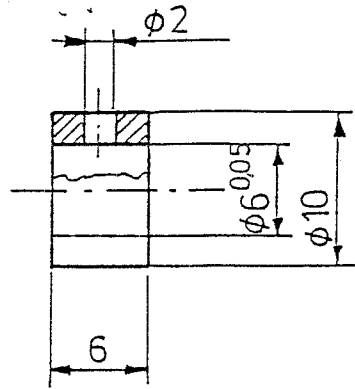

Maße ohne  
Toleranzangabe  
DIN 7168  
MITTEL

Entgratet

gültig ab Werk.- Nr.: 6500

Alle Rechte vorbehalten. Ohne unsere vorherige schriftliche Zustimmung darf dieses Dokument weder vervielfältigt, firmenfremden Dritten zugänglich gemacht, noch in sonstiger Weise verwendet werden.

Lfd. Nr.	Stückzahl	Benennung	Seit-Nr.	Form mit A	Bemerkungen	Gewicht (errechnet)
----------	-----------	-----------	----------	------------	-------------	---------------------

16 ST/FLGZ.							
		1989	Tag	Name	Werkstoff	Oberflächenzustand	Oberflächenschutz
		Bearb.	13.12	Jütk	1.4541	6,4	
		Gepr.					
		Norm.					
				Benennung			Maßstab
				LAGERHILFSRING			2:1
				Zeichnungs-Nr.			
				109 B-1125			
				Ersetzt für			P-Nr.
				Ersetzt durch			
Änd. Zurt.	Änderungs-Mitteilung	Tag	Name				
-	#M 217-11	15.1.30	Jütk				

